

**58 GILBERT WAY, BRAINTREE CM7**

**£1,650 PER MONTH**

**3 Bedrooms | 1 Bathrooms | 2 Receptions**

## Floor Plan

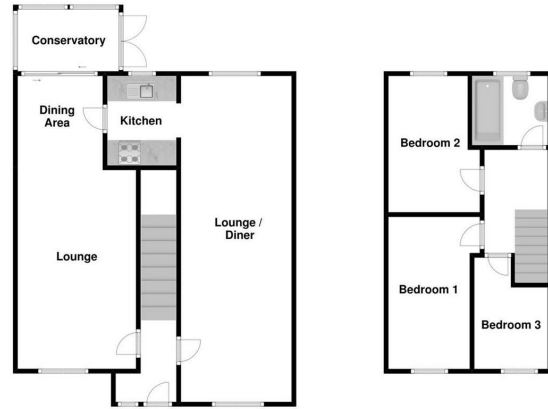

This floor plan is not to scale and is for illustrative purposes only. We make no guarantee, warranty or representation as to its accuracy and completeness.

## Area Map

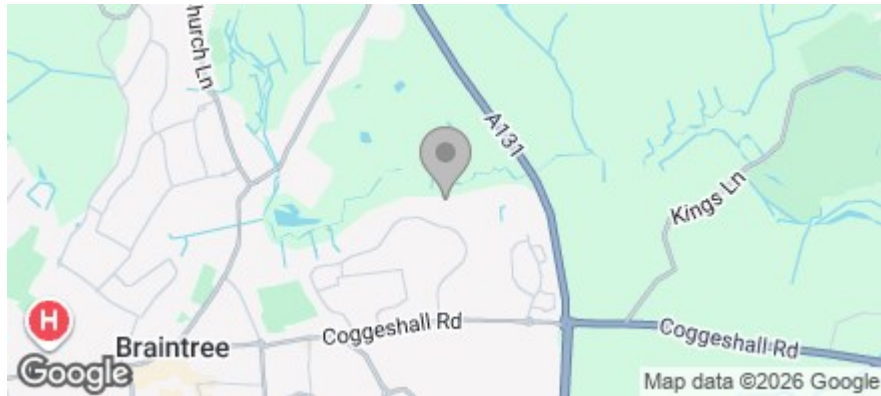

## Accommodation

- THREE BEDROOMS
- EXTENDED WITH THREE RECEPTION ROOMS
- CORNER PLOT
- GENEROUS DRIVEWAY FRONTAGE
- IMMEDIATE ACCESS TO THE BLACKWATER NATURE RESERVE
- WALKING DISTANCE OF LOCAL AMENITIES
- CONSERVATORY
- EASY MAINTENANCE GARDEN

## Viewing

Please contact us on 01376 386555 if you wish to arrange a viewing appointment for this property, or require further information.

## Energy Efficiency Graph

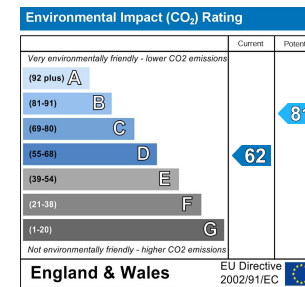
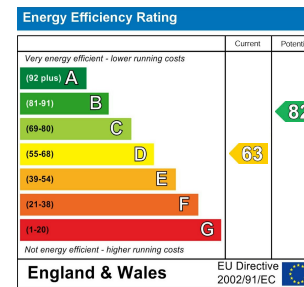

**Phone:** 01376 386555  
**Email:** info@branocsestates.co.uk  
**Website:** www.branocsestates.co.uk

Phoenix House 5 New Street  
 Braintree  
 Essex  
 CM7 1ER

Branocs endeavour to maintain accurate depictions of properties in Virtual Tours, Floor Plans and descriptions, however, these are intended only as a guide and purchasers must satisfy themselves by personal inspection.

